

8 7 6 5 4 3 2 1

F  
E  
D  
C  
B  
A

F  
E  
D  
C  
B  
A

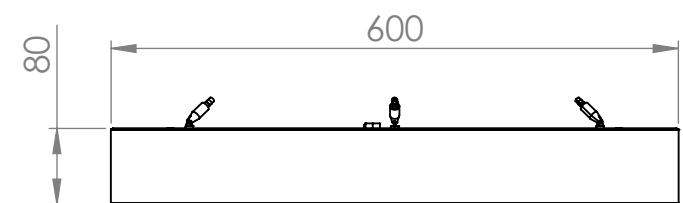
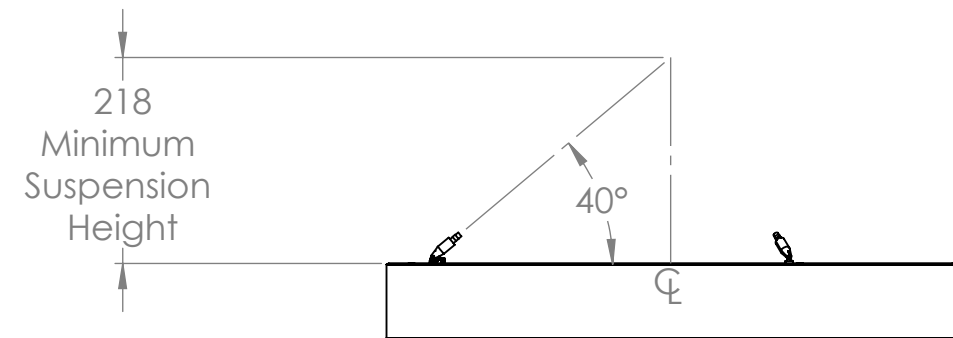

PART NUMBER	POLO-600-80
DESCRIPTION	Polo 600mm Outside Dia Slimline Profile
LIGHT SOURCE	LED Strip mounted to gear tray. 2700k as standard.
WIRING	30W LED driver provided. To be installed remotely.
SUSPENSION	3 catenary wires from a ceiling cap to clutches. Wires 3m as standard. min suspension height applies.
MATERIALS	Steel wire frame with fabric covered PVC panel sides. White aluminium composite gear tray in top and opal acrylic 030 diffuser in bottom.
WEIGHT (estimated)	1.9Kg

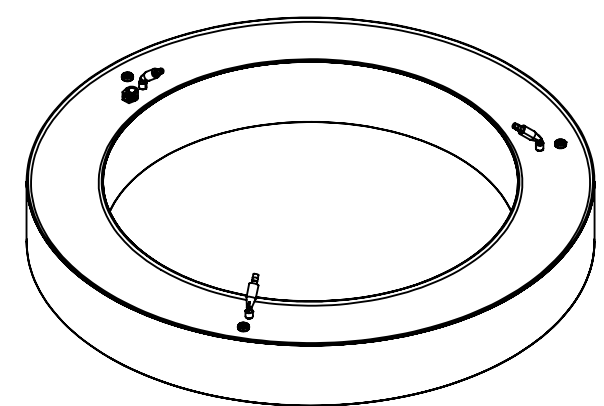
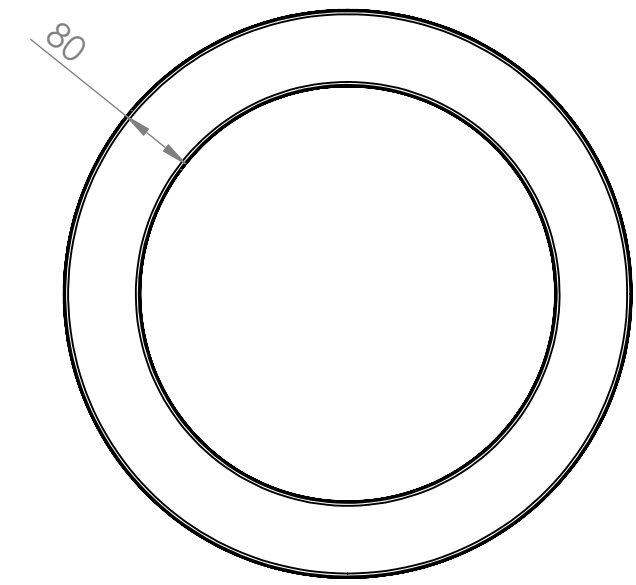

8 7 6 5 4 3 2 1